

Pg 198

Saml. Holland

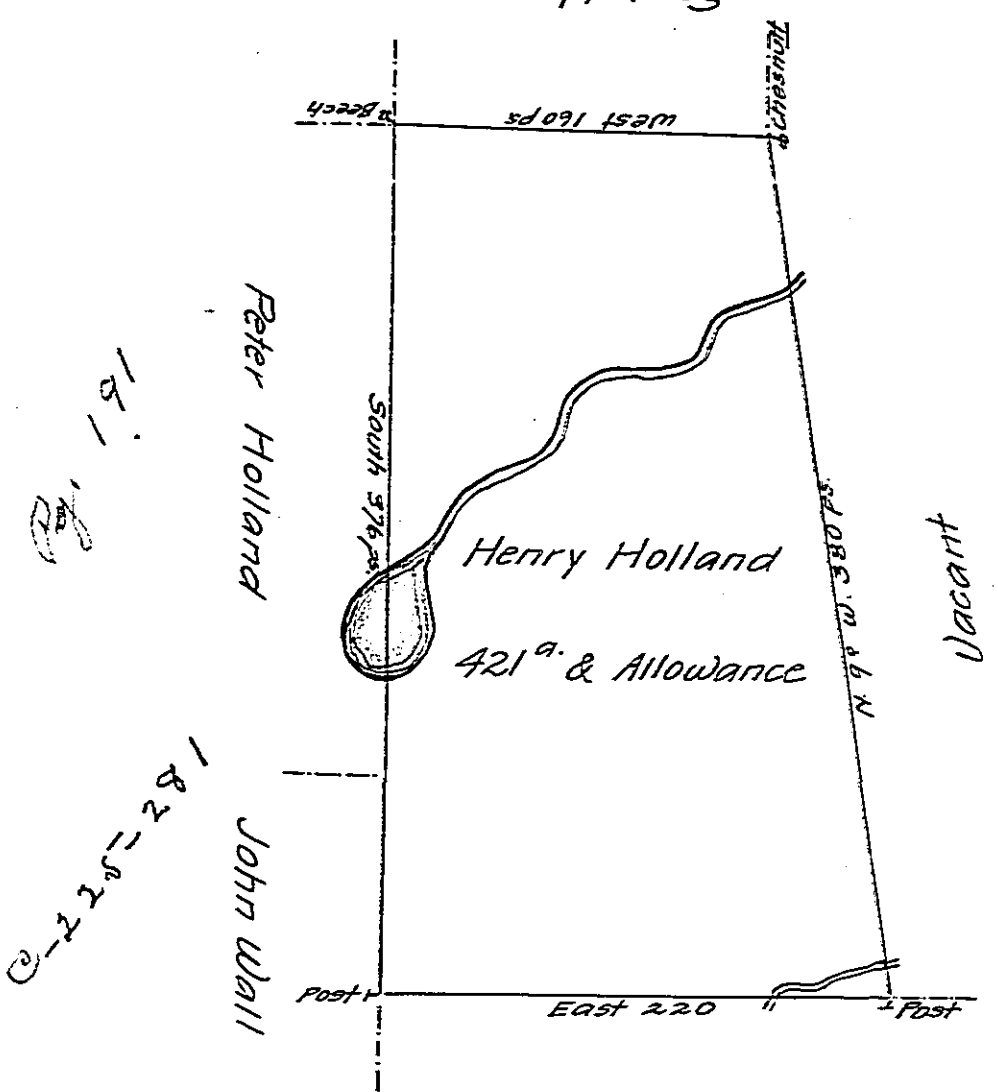

James Holland

Page 190

A Draught of a Tract of Land Called — Situate on the
 Waters of Salt Lick Creek, Adjoining Land of James Holland and
 others, in Stoke Township, Northumberland County, Surveyed on the
 26th day of April 1785 for Henry Holland by Virtue of his Warrant
 dated the 4th day of April 1785 Containing four Hundred and Twenty
 One Acres and allowance of Six p.Ct. — Roads &c.

by Wm. Gray D.S.

To John Lukens Esq. }
 Surveyor Genl. }

now Luzerne County

IN TESTIMONY that the above is a copy of the original remaining on file in
 the Department of Internal Affairs of Pennsylvania, made
 conformably to an Act of Assembly approved the 16th day of
 February, 1833, I have hereunto set my Hand and caused
 the Seal of said Department to be affixed at Harrisburg,
 this fifth day of June 1905

Isaac N. Brown
 Secretary of Internal Affairs.